

# spindle heads

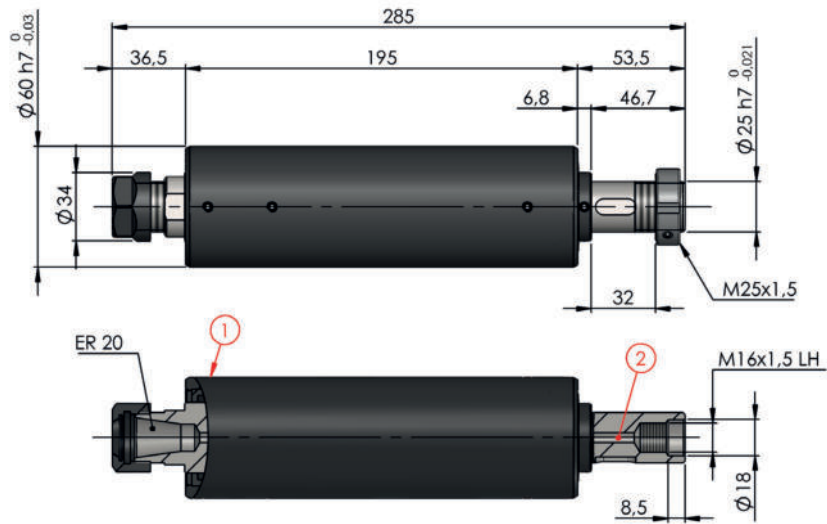

## teste mandrino



	bearings / cuscinetti
T	roller bearings a rulli conici MAX 6000 rpm
H	precision ball bearings a sfere di precisione MAX 12000 rpm

	spindle / mandrino
E2	ER20 DIN 6499



- Air inlet 0.5bar for internal spindle pressurization (1).
- Spindle with bore for toolholder drawbar (2).
- Optional: coolant through drawbar and rotary union.



- Ingresso aria 0,5bar per pressurizzazione interna mandrino (1).
- Mandrino forato per passaggio tirante (2).
- Su richiesta tirante forato per passaggio lubro-refrigerante e giunto rotante.



	bearings / cuscinetti
T	roller bearings a rulli conici MAX 5000 rpm
H	precision ball bearings a sfere di precisione MAX 10000 rpm

	spindle / mandrino
S3	ISO30 DIN2079
S4	ISO40 DIN2079

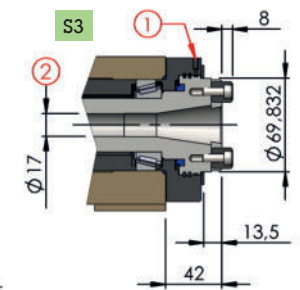
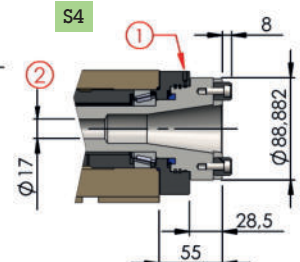
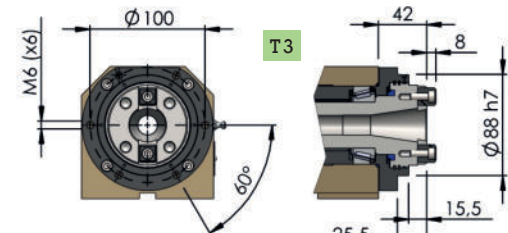
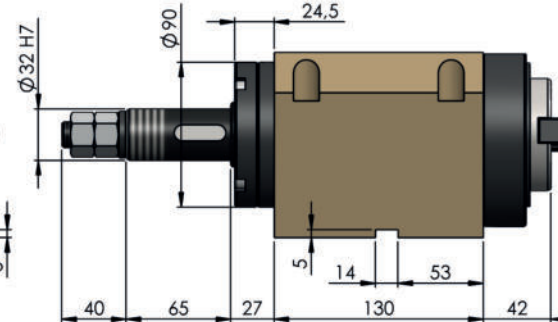
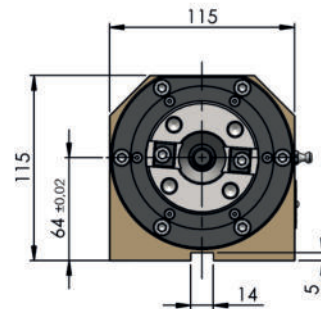



# spindle heads

## teste mandrino

### SH30

	bearings / cuscinetti
T	roller bearings α rulli conici MAX 5000 rpm
H	precision ball bearings α sfere di precisione MAX 10000 rpm

	spindle / mandrino
S3	ISO30 DIN2079
S4	ISO40 DIN2079

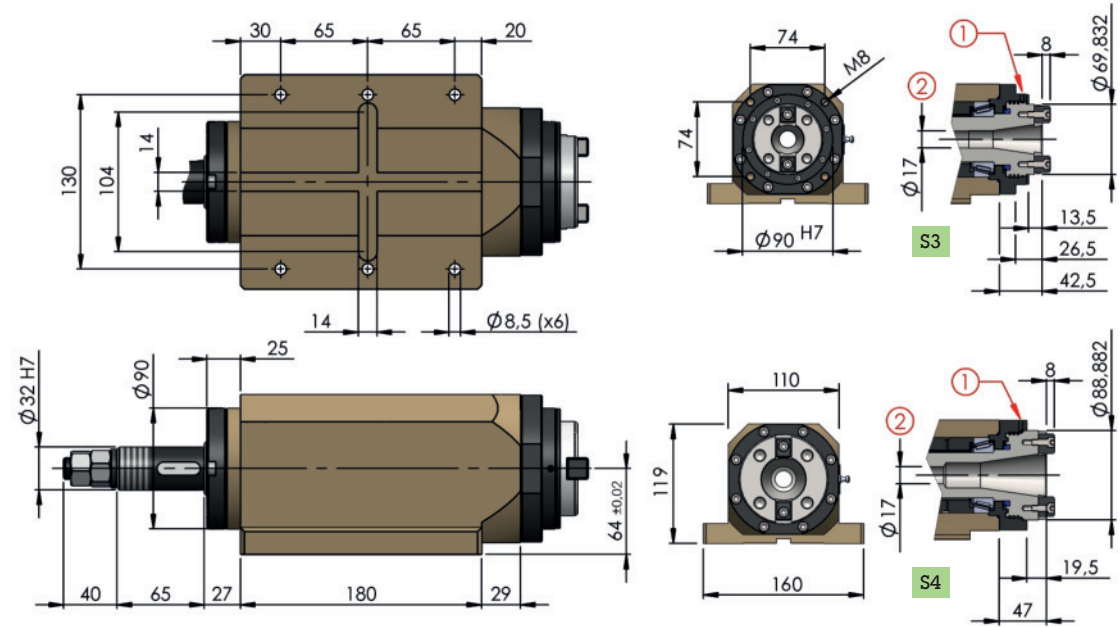

- Air inlet 0.5bar for internal spindle pressurization (1).
- Spindle with bore for toolholder drawbar (2). —
- Optional: coolant through drawbar and rotary union.

- Ingresso aria 0,5bar per pressurizzazione interna mandrino (1).
- Mandrino forato per passaggio tirante (2).
- Su richiesta tirante forato per passaggio lubro-refrigerante e giunto rotante.

### SH45

	bearings / cuscinetti
T	roller bearings α rulli conici MAX 3500 rpm
H	precision ball bearings α sfere di precisione MAX 8500 rpm

	spindle / mandrino
S4	ISO40 DIN2079
H6	HSK63-C DIN69893

